

IP54 enclosure transformers

Encapsulated transformers for swimming pool lighting

Single-phase safety protection transformers encapsulated in a plastic box with protection ratings up to IP54 are mainly used for supplying pool lights, but also for other applications where a high protection transformer is required.

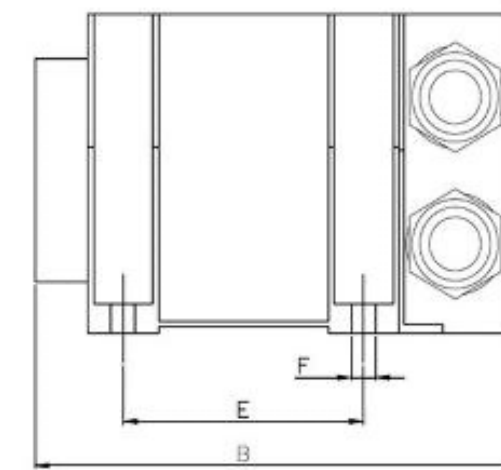
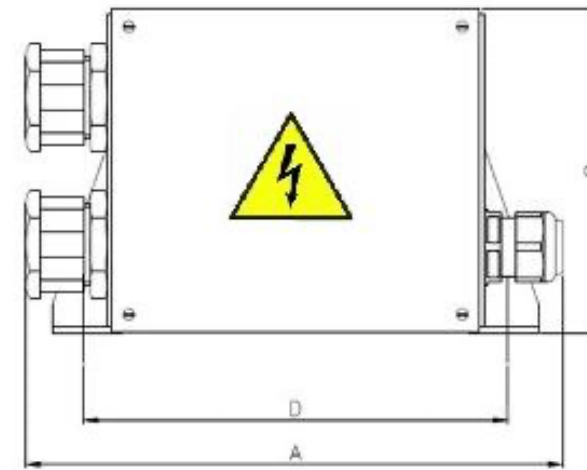
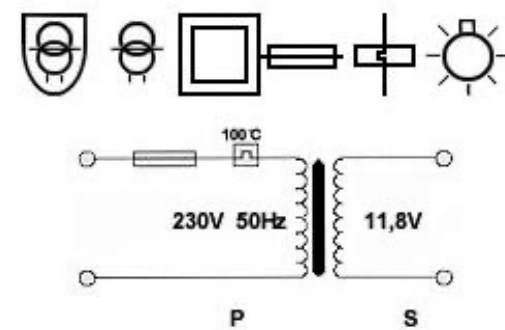

TYPE	CAPACITY [VA]	DIMENSIONS [mm]						WEIGHT [Kg]
		A	B	C	D	E	F	
Transformer TR9600/60 SWS	1x50	150	106	80	103	33	6	2,0
Transformer TR9600/105 SWS	2x50	150	120	80	103	45	6	2,3
Transformer TR9600/105 SWS	1x100	150	120	80	103	45	6	2,3
Transformer TR9600/200 SWS	2x100	165	140	89	115	65	6	4,4
Transformer TR9600/300 SWS	1x300	200	155	115	150	65	9	6,0
Transformer TR9600/300 SWS	2x300	200	175	115	150	85	9	8,0

THERMAL CLASS:	B130°C
SHORT-CIRCUIT RESISTANCE	CONDITIONALLY SHORT-CIRCUIT RESISTANT
PROTECTION CLASS:	II.
PROTECTION:	IP54
PROTECTION:	THERMAL FUSE REVERSIBLE 120°C
VOLTAGE WITHSTAND:	4,75kV
OUTLETS:	CABLE OUTLET PG
ENCAPSULATING COMPOUND:	POLYURETHANE
AMBIENT TEMPERATURE:	ta40